

PRODUCT	TYPE
Spa Table	MLR Select Alu

**Description:**  
The MLR Select is the further development of the MLR Classic and, unlike its predecessor, has lowerable and swivelling armrests. The spa table is available in three different versions: Alu, Wood and Static. The elegant and simple design provides optimum space for the therapists' legs. Two strong lifting columns allow the height adjustment and the inclination of the bed. The lowerable armrests as well as the adjustable head, back, leg and foot sections make the MLR Select a versatile spa table.  
As an option, the bed can also be equipped with the integrated Smart-Thermo heating system and other features.

**Key Features:**  
basement in modern aluminium design // swivelling and lowerable armrests // face cradle height, incline, back and foot section electronically adjustable // Trendelenburg function // hand switch with double-click // with lock function and 8 memories // PU or synthetic leather upholstery

**Specifications:**  
height: 61 cm - 97 cm // length: 200 cm// width: S: 76 cm / M: 85 cm / L: 92 cm  
lifting capacity: 300 kg // load capacity of the bed sur face: 350 kg



- Optional extras (prices on request)**
- Medium width (85 cm)
  - Large width (92 cm)
  - Soft upholstery
  - Pro version, manual ( fold-out foot rest )
  - Pro version, electrical ( fold-out foot rest )
  - Dual headrest
  - Built-in heating system
  - Scent diffuser
  - Magnifying lamp 'Circle'
  - PU or synthetic leather - special color
  - Ferrari Stamskin - special color
  - Base in aluminium (RAL ELOX)
  - Foot switch with cable
  - Foot switch with Bluetooth

Pro version with adjustable foot rest:



Illustration pictures - offered options and colors might differ

<b>Basic version without surcharge:</b>	
Size:	Small
Upholstery PU:	White or Choco
Metal Components (except for lifting columns):	titanium RAL 9007, white RAL 9016 or black-brown RAL 8022

**Gharieni Group certifications according to ISO13485:**  
CE marked  
Made in Germany  
TÜV certification



3 years full warranty (on all components), 5 years on actuators, 10 years on metal frames

PRODUCT	TYPE
Spa Table	MLR Select Alu

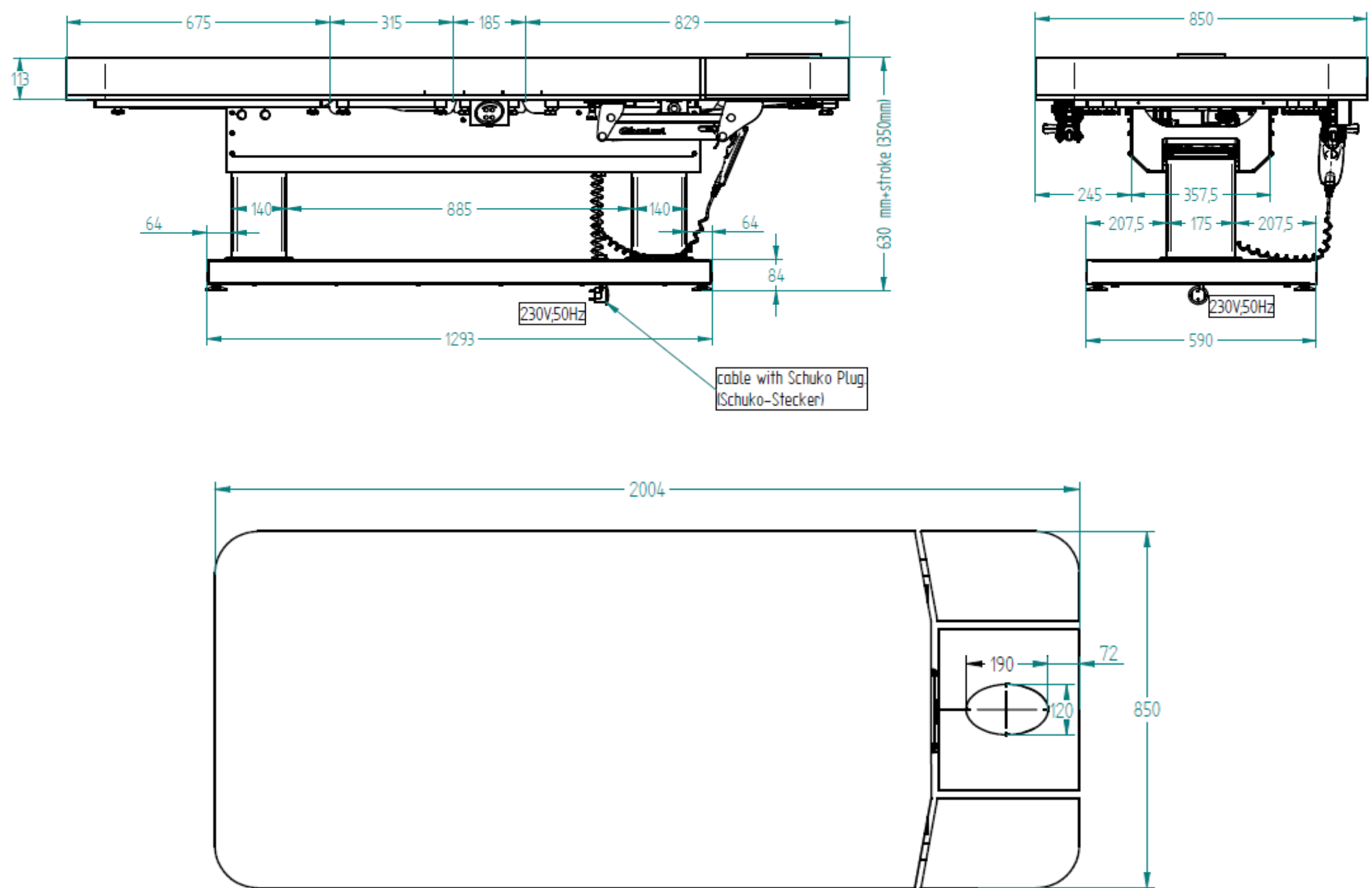

**Gharieni Group certifications according to ISO13485:**  
CE marked  
Made in Germany  
TÜV certification

3 years full warranty (on all components), 5 years on actuators, 10 years on metal frames

